

Burning Flipside

Survival Guide 2011

You must read this SURVIVAL GUIDE to attend. There WILL be a quiz.

It is a Bad Idea



Sean

You've always known this: Flipside is, in and of itself, a bad idea. And so, we found it only fitting to select "Bad Idea" as our theme for Flipside 2011. This is, of course, a VERY bad idea. But it does roll off the tongue well...so let's get creative.

Bad ideas usually start with a swagger...and often end with a Darwin Award. But there are times when a bad idea becomes the stuff of Legend. Flipside is a prime example of a bad idea spawning bits of myth and legend scattered across the globe. How many times have you heard "This one time, at Flipside..." followed by a vain attempt to verbally express something mythic that happened at Flipsides of yesteryear?

This year, we chose to pay homage to the bad ideas of yesterday, tomorrow and today. Think Bizarro World, or some parallel Earth where the best Bad Ideas are creatively and artistically expressed. High fashion is rabid monkey handbags with the right pair of stilettos and a pants cannon slung across your back. It's a world where sharks have laser-beam eyes, and cows are genetically engineered with wings. There are so many bad ideas out there and oh-so-many artistic ways to express them. Bad Idea is a choice. It's the freedom to make that choice to take a new road, the path unbeaten, to creatively set the tone like never before. And to do it brazenly, knowing that whatever the outcome, you are strong enough and smart enough to make it work. It's a bit wild west, pioneer, explorer, conqueror, mad scientist, aviator, crotchety old fart, and most of all...Burner.

What is Flipside?

Burning Flipside is an experiment in collaborative community featuring art and music created by those who attend. Attendees are known as participants (there are no spectators at Flipside; everyone collaborates in some way to create the event). Inspired by the Burning Man festival, it is a place for radical self-expression and an experiment in temporary community building. It is a place of acceptance, inclusivity and respect. It is organized entirely by volunteers. The art and entertainment is created solely by participants. There are no concession stands. No cash transactions (except ice sales) are permitted at Flipside - even bartering is discouraged. This is a sincere experiment in creating a gift economy. If you need something, ask for it. If you have it, gift it! There are no garbage cans: everyone is responsible for packing out their garbage.

Burning Flipside is a blank canvas: expect nothing...bring everything.



Contents

Burning Flipside Principles	3
Community Priorities	4
Plan Ahead.....	5
Policies	7
Safety	10
Services	12
Preparation.....	14
Map.....	15



Glossary

Area Facilitators (AFs) - Volunteers that manage teams of leads and are responsible for broad areas of the event. Proven level of awesome.

Combustion Chamber (CC) - A diverse group of volunteers who represent the community and advise the LLC. Could be you.

DaFT - Design and Fabrication Team. These people turn a big bonfire into epic beauty.

Leads - Leads are volunteers that manage specific functions for the event. Many leads also manage teams of other volunteers. You may find yourself...

AAR, LLC - The Austin Artistic Reconstruction, LLC (limited liability company) are the organizers and hosts of the event. Also, real, nice people.

MOOP - Matter Out Of Place. This is the common term for crap on the ground that doesn't belong there. We don't have garbage cans or maids. Pick it up!

Mutant Vehicles - Commonly known as "art cars." The DMV (Department of Mutant Vehicles) handles registration of mutant vehicles for the event.

PETs - Pyropolis Emergency Team. This is the on-site medical emergency team, which is awesome to have handy when needed. Don't forget, pet a PET.

Rangers - Khaki-clad volunteer conflict mediators and mobile info booths! Always ready to help.

Sanctuary - In Pyropolis, this is a place as well as an idea. If you are having a hard time coping with something, these people can lend an ear: for more information, ask a Ranger.

Burning Flipside Principles

Self Expression

Our events foster an environment of creative self-expression, where participants feel supported to honestly express their inner selves, through artistic creation, performance, and in their social interactions.

Accountability

Our events foster an environment of personal accountability, where we hold ourselves responsible for our own actions, and take personal responsibility for meeting our own needs, for the event itself, and for the event's impact on the world at large.

Cooperation

Our events foster an environment of cooperation, where participants work together to resolve potential conflicts respectfully, to help mediate conflicts between others, and to create art, performance, and social space on a larger scale than one person could alone. Additionally, participants seek to keep events sustainable by volunteering, cleaning up after themselves, and assuming personal responsibility for conducting themselves in accordance with local, state and federal laws.

Leave No Trace

- If you bring it in, you are responsible for taking it out. There are no trashcans at Flipside. Participants are responsible for disposing of their own trash and recycling materials.
- Have separate containers for recycling. Bring drinks in crushable aluminum cans instead of heavy/breakable glass.
- Think ahead about how you will deal with wet and dry trash.
- Start with less trash: buy in bulk or remove excess packaging before you go.
- If you are in a theme camp, get together with the others in your camp and make a camp-wide plan for cleaning up.
- For your personal camp area, make sure you take time to pick up MOOP (matter out of place - see glossary).
- Bring at least two extra trash bags more than you will need for your camp's trash and recycling.
- Never let it hit the ground. Be an Earth Guardian for your camp and make sure things are kept tidy.
- Plan to spend two hours before leaving combing through communal areas for litter.
- Information about recycling and local landfills will be available on the main field at the event.



This is a Leave No Trace event





Ryan James

Community Priorities

Effigy

We reserve the right to burn the effigy at any time or not at all depending on weather conditions. The effigy burn is planned for Sunday evening. Pay attention on-site for schedule changes. In the rare chance the effigy is to be burned early, we will do everything we can to ensure that the community knows of the early burn.

Involvement

Can't wait for Flipside? Then don't wait. Make stuff happen every Wednesday night at Church Night! What is Church Night? Church Night is community building, literally. Wanna meet people? Have a project idea and want to find help or get feedback? Projects come in all sizes. Paint signs or cigarette butt tins. Every Wednesday evening starting around 7 pm at the AAR Warehouse (1023 Springdale Road, Austin, Texas.)

Personal Boundaries

Self Expression and Cooperation require a social contract to make our event a safe place to play.

1. Respect the personal boundaries of others.
 - Respect the moment. Comfort levels vary at different times and with different people.
 - Before you assume someone wants your physical attentions, ASK. Being direct is not a buzz-kill obligation; it is expected protocol.
 - NO means NO.
 - After someone has said NO, cajoling, pleading, or any form of emotional blackmail is UNACCEPTABLE.
 - Respecting personal boundaries includes taking pictures or video, as well as physical and verbal interaction.

2. Take responsibility for your own boundaries.
 - You must be able to say NO.
 - Be sober enough to be in control or make arrangements with a friend to have a "designated driver."
 - How you feel is not magically telegraphed to others. YOU are in charge of your boundaries.
 - You are responsible for yourself but you can always ask for help. Talk to those around you (or a Ranger) if someone is making you uncomfortable.

Sound

- Flipside is organized into areas by sound — "Loud" "Really Loud" and "Slightly Less Loud". There is no guaranteed quiet zone. Plan ahead with earplugs, other sleep aids, white noise machines, etc.
- That said, we have someone who coordinates the sound for Theme Camps.
- And you can always ask nicely for someone to turn it down. Please consider that it's one weekend and earplugs are super cheap.
- Get extra for your friends.



Ryan James

PLAN AHEAD

Art

- NOT bringing art to Flipside is a Bad Idea – What are you bringing? Where do you want to put it? What do you need to make it go?
- Register your installation or piece so we can point folks your way and help get you the resources you need! See the Art section on burningflipside.com or email art11@burningflipside.com.

Broadcasting

If you want to run a low-power FM station at Flipside, you must contact the event organizers prior to the event for approval at llc@flames.burningflipside.com.

Burnable Art

- Burning art is part of our culture at Flipside. It is a symbolic celebration of the cycle of life and death—we don't dwell in what we've done so much as we celebrate what we can do.
- Texas is often dry in the summer despite rain. The land is filled with beautiful old trees, so fire could spread quickly.
- IF YOU PLAN ON BRINGING ART THAT YOU WANT TO BURN: you must contact the Burnable Art Lead(burnableart11@burningflipside.com) in advance for approval and coordination.
- There is no guarantee that your art will burn. Plan other creative ways to destroy your art that are less reliant on the weather.
- Don't ever throw toxic or dangerous things into any fire!

Children

- For the protection of minor children and in accordance with Texas law, any minor child attending this event must be accompanied by someone with legal authority to make decisions for the child.
- A minor is anyone under the age of 18.
- Bring everything your children will need to have a safe and enjoyable event.
- Bring proper documentation to prove your authority to make decisions for the child. For the child: birth certificate, passport, or other official document. For the parent: photo ID. An electronic copy of your documentation will be stored along with the signed

event waiver. A special affidavit process is also possible.

- You are solely responsible for the care, supervision, and well-being of the child AT ALL TIMES. There may be activities not suitable for children or behavior that you may not wish your children to see. Do not expect anyone to censor their behavior because children are present.
- Sign an event waiver of liability for the minor child, including a statement that you have authority to act on behalf of the child.
- Do not expect anyone in the community to watch your kids unless a specific agreement is made prior to the event.
- Inability to take care of the minors you bring to the event can result in ejection
- If you have any questions, contact AAR, LLC llc@flames.burningflipside.com.



Commercial Media

Burning Flipside is a private event. Commercial use of photographs, video, film or any other medium taken at Burning Flipside is prohibited without prior written permission of Austin Artistic Reconstruction, LLC.

Approved, professional media will receive a camera tag indicating that they have been approved and have been informed of our community expectations for the media. Additional information on the Burning Flipside media policy is available in the Commercial Media Agreement. Anyone encountering a problem with a photographer or videographer should report it to a Ranger. For information on requesting permission for the media and commercial photography or video, please visit the Burning Flipside web page at www.burningflipside.com/media. (Note: there are NO comp tickets available for members of the media, and you must provide supplies and shelter for your entire crew.)

Mutant Vehicles

If you want to cruise the grassy playa, you must have DMV tags. All other cars must be parked during the entire event. To have an art car roam:

- 1) register before the event
- 2) undergo an on-site inspection
- 3) submit to on-site safety inspection/interrogation/ indoctrination to receive DMV tags

Improper use of a mutant vehicle can result in the revocation of your DMV license. To register your mutant vehicle, contact the DMV lead at

dmv11@burningflipside.com

Recreational Vehicles (RVs)

- No in and outs for RVs
- Must be parked and left stationary during event
- NO hookups or pumping available
- If camping in a Theme Camp, please make sure the Theme Camp informs Placement of the number and size of RVs in your camp.
- City Planning may ask you to relocate your beast if it is deemed an obstacle.



Porn



Ryan James



Cate

POLICIES

Ejection

Austin Artistic Reconstruction, LLC, reserves the right to deny entry to the event or to revoke event access at any time for any reason or for no reason whatsoever.

Entrance Policy

No one will be allowed into the event without a ticket, signed waiver of liability, and valid ID. If you are bringing minor children, additional documents will be necessary. (See Children). You cannot gain admittance by volunteering. Tickets will not be available for purchase at the gate. Keep your ticket handy.

Fires

If you are planning fire activities, contact the Safety Area Facilitator at **Safety11@burningflipside.com**. If there is a burn ban, no fires will be allowed at all, not even those in burn pits. If there is not a burn ban, be respectful of the land when using fire:

- Use burn barrels or pre-made fire pits. Do not damage the land. **DO NOT LEAVE A FIRE UNATTENDED.** If using ANY fire or flammable materials, bring a fire extinguisher and know how to use it.

If you are a fire performer:

- Have a 'safety' at all times.
- If there is a burn ban, all fire performances must be in designated areas. Read the Flipside Flame or check with Greeters when you arrive.

Fireworks and Firearms

Fireworks and weapons are prohibited and grounds for immediate ejection from Flipside.

Gate

The first folks you'll encounter are the Gate staff.

- The Gate is staffed by a private company working with AAR, LLC to provide impartial services for the thousands reating Pyropolis.
 - Gate is NOT Greeters. They aren't there to make sure you feel the Flipside Superlove. They process your ticket, make sure you're adequately prepared and not sneaking someone in. Then they send you to the Greeters.
 - Wait until you arrive at Greeters to refresh yourself or take off some of those warm clothes and begin your Flipside experience.
 - Follow all requests from Gate staff. Giving them attitude will NOT get you into the event any faster.
 - You'll have to sign some waivers. Please print your name **LEGIBLY** where appropriate.
 - Gate staff will apply your wristband. It's not their job to care about your infringed rights or how you're going to catch Gonno-Sypho-Herpalitis from wearing them.
 - PLEASE keep all ticket information updated. If your cousin will be using your extra ticket but their name isn't in the database, **MAKE SURE IT'S UPDATED ON THE TICKET WEBSITE!** It makes things faster. Faster is better.
 - Be nice to Gate. They're super-awesome folks who do a non-glamorous yet essential job for our community.
- Gate Hours are:
- Thursday, Friday & Saturday (May 26-28): 9am – Midnight
 - *Do not show up early: you will not be admitted!*
 - Sunday, May 29: 9am – 6pm. No one will be admitted after 6pm on Sunday. Greeters need a chance to enjoy the Burn too!
 - Monday, May 30 – You must leave the property by 5pm.



Gate



Matt R

GTFO

The property **MUST** be cleared by 5pm on Monday, except for essential crew who have signed up **BEFORE** the event. If you are not packed and ready to leave by 5pm, you will be asked to leave without your stuff and return the following weekend to claim it. (The following weekend will be for infrastructure and clean-up operations only. No lounging. No staying.) **NOTE:** The Cleanup Team will **NOT** be taking volunteers on-site.

In & Out Policy

In & Outs at the gate are discouraged. If you leave, to get back in, you'll need:

- \$10 for a re-entry pass
- your Flipside ticket
- some form of identification when you return
- return only during gate hours
- wristband

Lasers

We like blinky. We like lasers. We don't like anyone getting blinded by lasers. So here's a reminder: **don't ever stare into a laser. EVER.** If you bring a laser to Flipside, you are responsible for its safe and responsible use.

- Handheld lasers: **Don't EVER shine a laser in anyone's eyes.** It can blind a person.
- All Other Lasers: **MUST** be mounted 7 ft above the ground and **MUST** be pointed upwards into the treeline.
- If you have any questions or concerns, email the LLC at llc@flames.burningflipside.com.

Law Enforcement

We create a temporary city with its own rules. This city coexists within an area of real laws. Try to make that coexistence a peaceful one. Abide by all relevant local, state and federal laws. If you see law enforcement officers, be nice to them. AAR, LLC will cooperate with all local, county, state and federal officials. We all share an interest in having a smooth event.

Parking

- Parking will be extremely limited; please carpool.
- Park in designated areas away from camps.
- If you are sleeping in your vehicle and it is parked in your theme camp you must disguise, cover or otherwise get rid of its 'car-ness'. If a vehicle is not 'artified' you will need to move it to Parking
- You will be able to drop off camp gear using a temporary "drop off" pass, but then you will need to park in designated areas.
- RVs, trailers and other larger vehicles may be directed to reserved areas. (See RVs)
- All parking locations are subject to change.
- Vehicles parked in unauthorized or unlawful areas will be towed at owner's expense.
- Please secure your vehicles when you park!

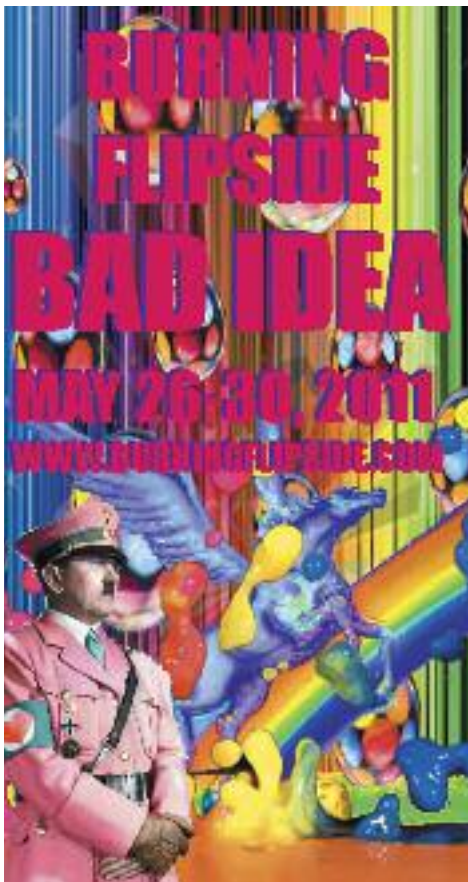

Kangaroo Sexy



Jennifer

Pets (animals, not the first aid kind)

NO PETS ALLOWED. If you bring an animal, you will not be allowed into the event. If you require a service animal, email llc@flames.burningflipside.com prior to the event.

Photography & Video

Burning Flipside is a private event. Redistribution or public display of images, including internet-based media, requires the explicit consent of all subject parties.

- ASK FIRST before you shoot! Many people are sensitive to photos taken of them at the event.
- Images may only be taken for personal use and may not be used professionally or for any commercial purpose without prior written approval by AAR, LLC.
- Videotaping for personal use requires a signed Personal Use Agreement, which indicates that the footage will not be used commercially.
- ALL motion-capturing cameras must be registered. Registration can be done at Greeters or the Ranger Station.

Safety Markers

Any intentional removal, destruction, or alteration of the safety lighting, event signs, or caution tape is grounds for removal from the event.

Social Media

Posting photos to social media sites removes your control of the photos and of the 'ask first' arrangement made with other participants. By posting, you give ownership of those photos to the social media sites. These sites retain those photos even if you delete them. Think twice before giving your art to social media sites.

Sound Systems

- If you are camping with a sound system, you MUST pre-register with theme Camp Registration.
- If your art piece involves loud

sound, you MUST pre-register with Art Registration.

- If your theme camp will be having amplified music or loud sound, you MUST pre-register it with Placement.
- If you are planning on creating anything with lots of sound, you MUST be familiar with and abide by the Burning Flipside Sound Policy, which can be found here: www.burningflipside.com/soundpolicy. You will be asked to sign a Sound Release Form upon entering the event. Contact the Sound Lead at sound11@burningflipside.com if you have any questions.
- Mutant vehicles making sound must also abide by the Sound Policy.

Trespassing

Don't cross fences, boundary tape, and other posted boundaries. The property lines may be in unexpected places. DO NOT CROSS THE BOUNDARIES OF THE EVENT. If you see a sign, respect it. Trespassing on private property is illegal and can be dangerous. Disregarding boundary signs can get you ejected from the event.

Vandalism/Art Defacement

Defacing (defined partially as, but not limited to, the actions of altering it or tagging it with paint) art or any other property that belongs to others, including the land and its trees, is NOT an acceptable exercise of self-expression. Anyone caught defacing any artist's work without that artist's express permission will be subject to both ejection from Flipside and any potential legal charges that the artist may wish to file against the person vandalizing the art or property, with the full support of AAR, LLC.

Wristbands

Everyone will be required to wear wristbands. Anyone found without a wristband will be ejected. Replacements can be acquired at the Gate.



Tatiana Miller

SAFETY

Driving

Many volunteer departments use golf carts as official vehicles. You must be authorized to drive an official vehicle. Participant-created art vehicles (cars, trucks, golf carts, etc.) must be registered with the Department Of Mutant Vehicles. Unauthorized or unsafe use of a vehicle can result in ejection from the event, liability for property damage, and even criminal charges.

Fauna

There are plenty of nasty critters all over Texas. This is not a definitive guide. Keep an eye out and try to avoid these creatures.

Ants

Pound for pound, the fire ant is the meanest animal to ever walk the face of this great planet. Carpenter ants, on the other hand, are pretty tame and endangered. Just to confuse you, both types are red. To be safe either way, put signage around ant beds so people know to avoid them. Ants don't like cinnamon, so pack some to put around your tent to keep these pests out of your stuff.

Mosquitoes

Mosquitoes are somewhat omnipresent in Texas during the summer. Use bug spray to prevent bites. Treat mosquito bites by cleaning the bite area and rubbing on Benadryl lotion or some other anti-itch lotion. Do not scratch the bite until it bleeds because bacterial infections are not hot.

Scorpions

- Scorpion stings can be painful, but they can be avoided.
- Kick a rock before picking it up.
- Shake shoes before putting them on.

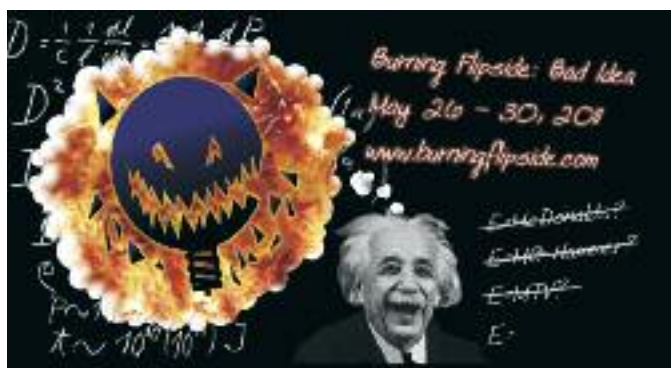

J Caddell

- If you are stung by a scorpion, wash the area with soap and water. Use ice to dull the pain.
- A sting can be dangerous or deadly to someone with a sensitivity to them. In most cases, they're gonna hurt like crazy but the pain will dull with time. If you experience unusual symptoms (shortness of breath, dizziness, vomiting), contact the Pyropolis Emergency Team (PETs) immediately.

Snakes

While many snakes are not harmful, go with the plan of mutual avoidance for safety. If you hear a rattle, stop and move slowly away from the sound. The water may contain water moccasins.

Ticks

- Ticks can carry diseases you do not want.
- The best ways to avoid ticks is to use insect repellent.
- When setting up, wear long pants and a long-sleeved shirt.
- Improper tick removal can cause infection. If you don't know how to remove a tick, ask the PETs for assistance.

Flora

Poison Ivy

Poison Ivy and Poison Oak have unique characteristics:

1. There are always an odd numbers of leaves per stem. 3 is most common, but can be 5, 7, etc.
2. While leaves are usually a lush green, the stems are red or mahogany.
3. Leaves are not uniform in shape. They may be approximately alike, but always at least subtly asymmetric.

If you think you have been exposed to Poison Ivy:

- Cleanse exposed areas with rubbing alcohol
- Wash the exposed areas with water only (no soap yet, since soap can move the urushiol, the oil from the poison ivy that triggers the rash, around your body and actually make the reaction worse)
- Now wash the area with soap and warm water
- Put gloves on and wipe everything you had with you, including shoes, tools, and your clothes, with rubbing alcohol and water.

- Keep a supply of products specifically for treating Poison Ivy (Ivy-block, Zanol, Ivy Cleanse Towelettes and Tecnu Extreme Poison Ivy Scrub). For more information visit www.poisonivy.us

Pecan Trees

The trees at the new land are beautiful, sacred, and fragile. Do not hang things from the trees, as that may cause breakage. The trees are part of a working agricultural orchard. **Do not paint, mark, cut, trim, drill or spike a tree for any reason. Doing so will be considered vandalism of private property.** We want to be invited back, so this falls under being respectful. Some art may be allowed to hang from trees, but advance planning is required. If you are bringing art and want to explore your verticality options, contact the art lead at art11@burningflipside.com.

Hydration

Dehydration is a very serious risk at Flipside due to the Texas summer heat. DRINK WATER, lots of it. Beer dehydrates you; it is not water. Water is not sold at the event (except in the form of ice), so bring all the water you will need. We strongly recommend a minimum of 3 gallons/per/day. Signs of dehydration:

- Feeling uncharacteristically cranky
- Rapid or sudden weight loss
- Increasing thirst
- Dry mouth
- Weakness or lightheadedness (particularly if worsening on standing)
- Darkening of the urine or a decrease in urination (drink enough water to “piss clear”)

The Water

The new land has a public waterway, the San Gabriel River, to cool off in. Before you hit the water, know:

- Swim at your own risk
- There are NO lifeguards on duty
- DO NOT SWIM ALONE
- Be alert to obstacles under the water (tree limbs!)
- It is not a pool, but real live flowing water downstream of a dam. Check first for signage before entering the water.
- Be alert to weather conditions. If there is rain in the area, water can rise rapidly. In case of storms, get out of the water.
- Be aware that the water is considered “public”

and is not a private swimming hole. While water traffic in the area is uncommon, it is possible. Media, law enforcement, and others may be using this public waterway. Consider the water like a public road. Please respect all local, state, and Federal laws, and the sensibilities of our neighbors.

Mutant Vehicle Etiquette

Mutant Vehicles can be seen and ridden at the event. All participants are responsible for interacting safely with Art Cars. Unsafe or unauthorized use of any vehicle can result in ejection from the event, liability for property damage and even criminal charges.

- THOU SHALL NOT
 - try to get on, impede, or stop a moving mutant vehicle
 - attempt to run down, jump on, hog-tie and/or flip-off the vehicle or its driver(s) if the mutant vehicle does not stop for you. Channel your disappointment and rage into something more creative like a slanderous mambo or vicious interpretive dance.
 - operate any mutant vehicle and/or its artistic additions (e.g., fire cannons, pants cannons, sounds and light systems, etc.) without permission of its owner(s)/operator(s)
 - hi-jack, hoodwink or harass the driver whilst they are in command and control of the mutant vehicle
- THOU SHALL
 - dance around, wave thy arms and ask politely from a safe location to get on a passing mutant vehicle
 - wait until the mutant vehicle has come to a complete stop and you have the operator’s permission before boarding or disembarking
 - help look out for the safety of their fellow passengers, passers-by and other sundry freaks
 - report any safety issues, violations, and/or problems to the Pyropolis Rangers immediately



Services - NOT Bad Ideas

Emergency Services (PETS)

The Pyropolis Emergency Team (commonly referred to as 'PETs') provides 24-hour first aid and emergency response for Burning Flipside. Every PET is a certified or licensed medical professional who is trained to treat injuries and, if necessary, work with the Rangers to evacuate patients with serious injuries or potentially life-threatening medical conditions. If you need a PET, they can be found at Ranger HQ, or contacted via your nearest Ranger or radio-wielding volunteer.

Ice

Ice will be sold at Flipside. Check for a map at Greeters to find out where Ice is being sold. Details will be announced on the lists and in the Flipside Flame.

Greeters

The Greeter Station is the place to step out of default reality and enter the one we create together. The Greeter Station may set up outposts during peak times. How to be Greeted:

1. Arrive at a Greeter station ready for some love!!
The Greeters will be super excited to see you!
By the way, Greeters love gifts, especially water, booze, and snacks!
2. You'll get out of your car and join small groups. Greeters will go over the highlights of the Survival Guide with you to confirm that you're setting good expectations and that you have all the necessities for a safe week (water, sunscreen, trash bags, food, etc.).
3. Once you have been Properly Greeted, proceed to your identified Pyropolis Zone. where you will be greeted by Zone Greeters who will direct you to your flagged theme camp spot.
4. You will have a window of a few hours to unpack and get your car to Parking: Please DO!

Pyropolis Fire Department

The Pyropolis Fire Department is made up of trained firefighters. They are located up at the PETs HQ. In an emergency, the fire team can be reached at Ranger HQ or via radio by any radio-wielding volunteer, including any Ranger, at the event

Port-o-potties

Port-o-potties will be located throughout the event and will be tended daily. Only the 3 Ps—Pee, Poo & Paper go into the potties. Seemingly harmless things like cups, baby wipes, lights, and incense can cause problems during cleaning. Nobody wants a problem cleaning a porta-pottie.

Rangers

Radical self-reliance and respect means you are responsible for your own actions. Make sure your actions don't interfere with the enjoyment of the event for others. This includes being respectful of your neighbors, controlling the volume of your camp, and working out disagreements respectfully. Rangers patrol the event and you can reach out to them if you need urgent help or assistance in resolving a conflict. They are not police; they are not The Man. Rangers are participants who volunteer to help make our event safe and smooth, so that we can all have more fun.

Recycling

Check with Greeters when you arrive for recycling locations. Recycling will be back this year, thanks to the wonderful efforts of the Recycling Lead and the citizens of Pyropolis.

Pyropolis Parks Department

- City Planning has set aside space for several 'beaches' along the river and 'pocket parks' located around the city for all to enjoy. The Island is the 'central park' of Flipside where all Flipizens can relax, make music and art, hang out with old and new friends, and always find peaceful refuge.
- We hope everyone enjoys the art and performances in parks. The parks and beaches will have no amplified sound unless part of a pre-arranged installation or performance. And we want to hear your ideas for Art in the Parks!
- These are YOUR parks and the Parks Department needs your creativity to help fill them.
- The Parks Department "Cares about YOU!" and your park rangers are a wealth of useful and useless information...ask them anything - they might even have the answer for you - they'll at least give you a cookie, a cuddle, or a chuckle.

- To volunteer to be a park ranger or to be part of Art in the Parks, please contact Sharrianna at parks11@burningflipside.com

The Island

The Island is Flipside's Central Park. Relax, make music and art, meet your friends or make NEW ones. To schedule a performance, teach a class or volunteer your time, contact the Pyropolis Parks Department at parks11@burningflipside.com

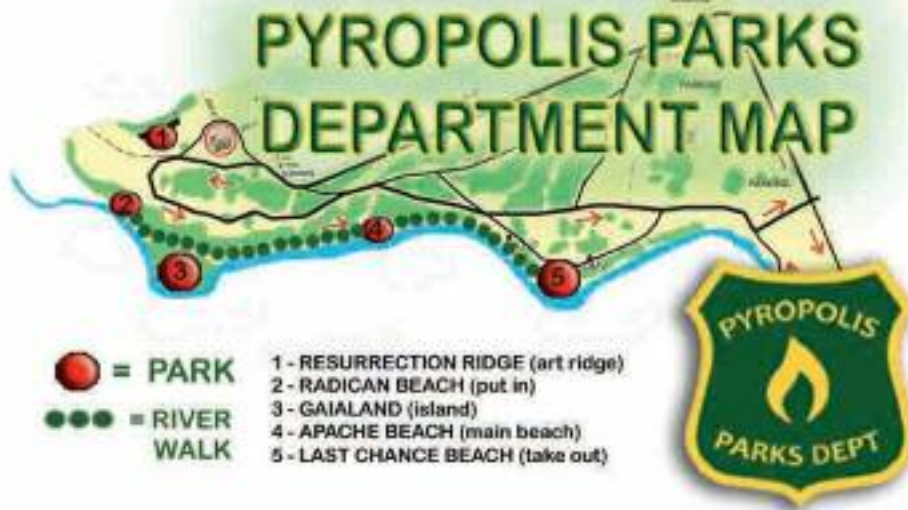

Apache Pastures is flanked on its southern border by the San Gabriel River. The banks of the river are mostly steep, muddy and full of trees and poison ivy. However, there are a few obvious access points that have been set aside as community space so that all of Flipside can enjoy the river.

RESURRECTION RIDGE: an open grassy ridge adjacent to the effigy field where larger art installations will be placed

RIVER WALK: a river front path extending along the river from Radican Beach to Last Chance Beach.

RADICAN BEACH: named after the plant that proliferates along the river bank – Toxicodendron Radican aka Poison Ivy. The bank here is steep and muddy and the water is swift. Enter at your own risk.

GAIALAND ISLAND PARK PRESERVE: a natural temporary island located in a bend in the river. A bridge has been installed for ease of access. There is also river access from the island and luckily, very little poison ivy exists on the island.

APACHE BEACH: the main beach located midway along the river front and is the easiest access to the river on the property.

LAST CHANCE BEACH is the downstream take out point for floaters and is located at the eastern side of the property. The beach is a gravel bar with areas of thick mud and is not the best place to hang out.



Holli M



Kelly Switzer

PREPARATION

What to Bring

Burning Flipside is an exercise in radical self-reliance. You must bring food, water and shelter. Gifts are a wonderful expression of community, but you must take responsibility for your own survival and well-being. Do not show up expecting the community to take care of you. Participants arriving with inadequate supplies will not be allowed to enter the event. Some recommendations on what to bring:

Necessities:

- Three gallons of water per person per day (for drinking, dish and body washing, food preparation, etc.). Keep a bottle of water with you at all times
- Enough food and beverages for your entire party
- First aid kit
- Bedding and shelter of some type (a good camp tent is recommended along w/sleeping bags)
- Single-ply toilet paper (the port-a-potties only get serviced once a day)
- Garbage bags (more than enough for all of your garbage—it's good to bring extra for MOOP that accumulates during the event)
- Portable ashtrays if you are a smoker (Decorated mint tins work great)
- All required prescriptions, contact lens supplies, toiletries, etc.
- Flashlights (headlamps are very useful)
- Extra batteries for everything
- Sunscreen and sunglasses
- Sturdy closed toe footwear
- A cup for beverages (several camps may have drinks to share, but you are expected to supply the container)
- Ice for the entire duration of your stay or cash for ice sales
- Common sense, an open mind, and a positive attitude

Recommended:

- Shade structures, umbrellas, parasols, sheets; things to break the cruel mid-day sun
- Ice chest(s) to store your perishable foods and beverages
- A cooking stove
- Cash for ice sales
- Portable showers (There are NO showers at the Apache Pastures!)
- Earplugs (not everyone will sleep when you do)
- Insect bite treatment/medication
- Watertight protective bags (e.g. heavy Ziplocs) for cameras, electronic gear, etc.
- FM Radio – some participants set up micro-power stations for your entertainment
- Blinky lights, toys, magical fabulousness and swell stuff to share; anything you think would make things more fun for you & your fellow Flipizens
- Handi-wipes
- Spray bottle (for misting)
- Rope, string, duct tape, zip ties
- Fuel for stoves, generators, mutant vehicles, etc.
- Abundant amounts of whatever makes your life better: beer, bacon, chocolate, coffee, powdered donuts.

If you are coming from out of town and have questions, please contact our Regional Outreach Lead at

RegionalOutreach11@burningflipside.com

Flipside Flame: flipsideflame11@burningflipside.com

The Flipside Flame is a great communication resource. Whether you contribute to it or just read it to find out what's going on, it's yours. Advertise your theme camp fundraiser, find out about events, and read about community issues.

Out-of-Towners

Any late-breaking news will be announced in the Flipside Flame.



Ryan James



BuckDown

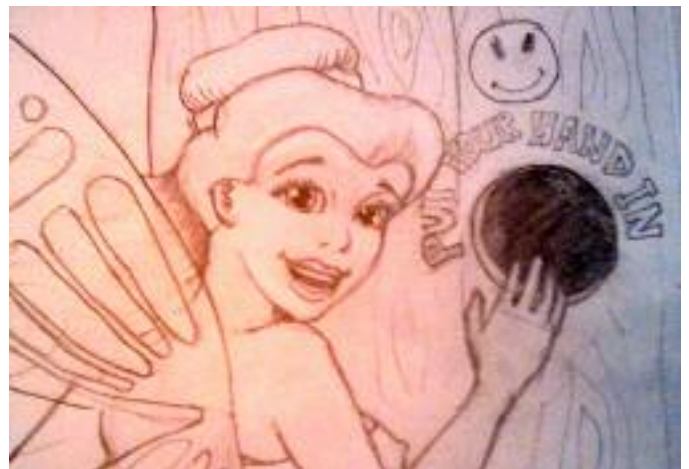

Sean French

Getting there

- Drive to Thorndale, TX, from wherever you're coming.
- Take FM 486 north to San Gabriel.
- Turn right in San Gabriel (the road is still FM 486).
- Travel 3.1 miles to the intersection of FM 486 and County Road 428.
- Bear right on Country Road 428 and travel 1.3 miles to the Flipside entrance.
- Drive through the property gate and present your tickets and IDs to the gate crew.
- Also see www.burningflipside.com/directions for directions from other cities.

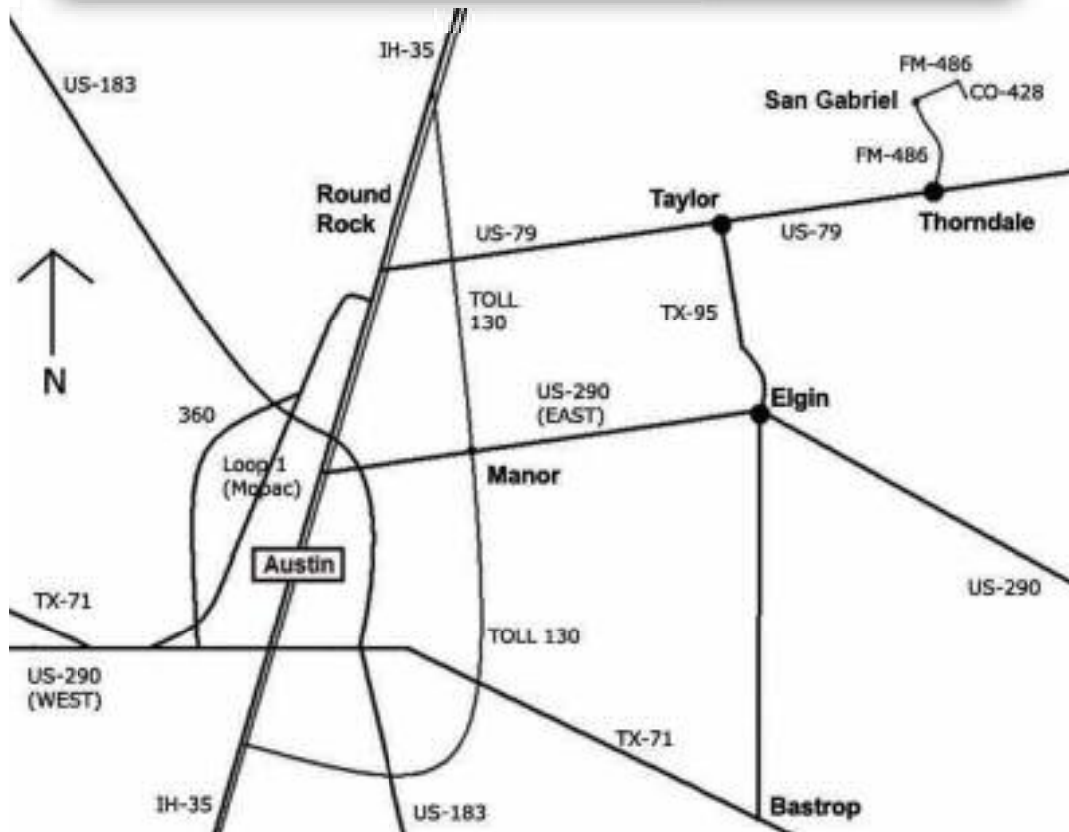

Local Businesses

Apache Pass Restaurant—Opening soon at Apache Pass, off of FM 908.

Brushy Creek Saloon—707 E Hwy 79 (North side), Thorndale.
Larger bar, average prices open from noon to late, 7 days a week

Steve's Place—111 E Salty St. (Off Main St), Thorndale.
A small bar, less expensive. Excellent burgers served after 6pm, Sat. 11am-3pm.

The Downtown Cafe—118 S. Main St, Thorndale.
(512) 898- 4116. Good folks and good food, near as we can tell. They can handle a crowd (up to 150 people). Catering available. Tell Louis "Howdy!" from the Burner crowd.

Steve's Cash Grocery—146 S. Main St, Thorndale.

(512) 898- 2614. Decent place to get fresh produce and other food items. Say howdy to Norman. We might wipe them out, so call ahead. 7:30- 6pm M-F, Sat 7:30-6pm.

Thorndale Community Lumber Co.—99 S. Main St, Thorndale.
(512) 898-2024. They also have a supply of hardware. 8-5pm M-F. Sat 8-12 noon

Thorndale Meat Market—204 W Hwy 79, Thorndale.
(512) 898- 5387. A good place for meat, especially bacon. Give a howdy from the Burner crowd. Call ahead if you have a special request. 7-5:30pm M-F. Sat. 7-12noon

CEFCO convenience store—201 E. Hwy 79, Thorndale.
(512) 898-2683. Especially convenient because it doesn't cross Hwy 79 and FM 486.

J&K Grocery (Shell)—101 E. Hwy 79, Thorndale.
(512) 898-2921. Will do special beer orders; deliveries are Tuesday and Wednesday. Call ahead.



Dragon Lee



Jim



One of Many

You voluntarily assume any risk of serious injury or death by attending.

You must bring enough food, water, shelter and first aid to survive a long weekend in rural Texas. Proper footwear and personal lighting are essential. You may encounter venomous snakes and insects, wild animals, thorns and poison ivy. Extreme heat and flash flood conditions are possible. Be Aware.

Vending, firearms, fireworks, rockets and all other explosives prohibited. Commercial use of images taken at Burning Flipside is prohibited without prior written consent of Austin Artistic Reconstruction, LLC.

You agree to abide by all rules in this Survival Guide. This is not a consumer event. Leave nothing behind when you leave the site.

- No Vending
- No Pets
- No Spectators
- Leave No Trace

Austin Artistic Reconstruction, LLC, reserves the right to deny entry to the event or to revoke event access at any time.

Tickets are Non-Refundable

To learn more about Flipside 2011 and how you can get involved, visit www.burningflipside.com.

Check out the Flipside Flame newsletter for updates



Recess



Rodan 2k



Rodan 2k